

# Crane

## **MINI RECHARGABLE AROMA FAN**

### **Instruction Manual**

FOR MODEL:  
EE-5619



If you have any questions about the operation of your fan,  
please contact Crane Customer Care.

**Toll Free:** 888-599-0992

**Email:** [customer-service@crane-usa.com](mailto:customer-service@crane-usa.com)

**Register Your Product Online**

<https://crane-usa.com/product-registration/>



**PLEASE READ AND SAVE ALL INSTRUCTIONS TO ENSURE  
THE SAFE AND EFFECTIVE USE OF THIS FAN.**

# **SAVE YOUR DATED PROOF OF PURCHASE!**

[ You will need this in case of warranty ]

staple  
tape  
or paperclip  
your  
receipt  
HERE

# TABLE OF CONTENTS

Table of Contents, Technical Specifications & Sustainability	P. 1
Safety Instructions	P. 2-3
List of Main Parts	P. 4
Operation & Use	P. 5-6
Maintenance, Storage & Customer Care	P. 6
Warranty Information	P. 7

## TECHNICAL SPECIFICATIONS

Rating Voltage	DC 5V
Wattage	5W/1V
Noise Level	≤55 dB

## CRANE & SUSTAINABILITY

Crane USA is dedicated to your environment both inside and outside your home. We know if cleaned and maintained properly, our products last for years helping to reduce unnecessary use of resources and emissions making new products.

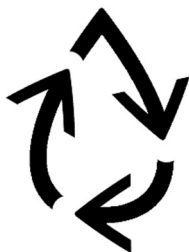

The Crane manual you are holding is from recycled materials with no added finishes or harmful dyes. If the fan should no longer operate, please be sure to dispose of the unit in an environmentally friendly way by taking it to a public collection point.

**PLEASE DO NOT PLACE BROKEN FAN WITH  
YOUR REGULAR HOUSEHOLD WASTE.**

# IMPORTANT SAFETY INSTRUCTIONS



**WARNING!** READ AND SAVE THESE INSTRUCTIONS. Failure to follow all of the instructions listed below may result in electric shock, fire and/or serious personal injury. **KEEP OUT OF REACH OF CHILDREN.**

1. Always turn the fan off before removing the plug from the power source. **NEVER PLUG IN OR UNPLUG WITH WET HANDS.**
2. To protect against electrical hazards, do not place the fan in water or other liquids. Do not allow the fan to become wet or damp.
3. Do not store the fan where it can fall into water or other liquids.
4. Do not store the fan unattended when it is plugged in. Turn the fan off when leaving it for an extended period of time.
5. Use the fan only for its intended use as described in these operating instructions.
6. Do not operate any appliance if its cord or plug is damaged, after the appliance has malfunctioned, or after it has been dropped or damaged in any way. Always follow the warranty instructions.
7. Place fan on a flat, level surface to avoid it overturning.
8. Avoid contact with moving parts.
9. Never drop or insert any object into any opening. Do not insert any objects into the area protected by guards.
10. Do not let hair, curtains, tablecloth, clothes, etc. near the openings of the fan. They could become entangled in the fan and cause damage or injury.
11. Do not put your fingers or any object into the front grill of the fan.
12. Do not obstruct the airflow.
13. Do not use this fan outside; it is for indoor use only.
14. Do not use this fan in damp areas such as a bathroom.
15. Do not use this fan near a window or under direct sunlight.
16. Do not operate the fan in an area where gasoline, paint or any such flammable liquids are used or stocked.
17. Unplug USB cord before moving, cleaning or storing the fan.
18. Always unplug the fan when it is not in use.
19. Close supervision is necessary when any appliance is operated near children. **DO NOT let your child play with this appliance.** Serious injury and electrocution may be possible. This appliance must be operated by an adult. Children should be supervised to ensure that they do not play with this fan.

**TO REDUCE THE RISK OF FIRE OR ELECTRICAL SHOCK, DO NOT USE THIS FAN WITH ANY SOLID-STATE SPEED CONTROL DEVICE.**

## SAVE THESE INSTRUCTIONS!

# GENERAL SAFETY INSTRUCTIONS



**WARNING!** Read and understand all instructions. Failure to follow all instructions listed below may result in electric shock, fire or serious personal injury. The warnings, cautions, and instructions discussed in this instruction manual cannot cover all possible conditions and situations that may occur. It must be understood by the user that common sense and caution are a factor which cannot be built into this product, but must be supplied by the user.

## SPECIAL INSTRUCTIONS

- To avoid a circuit overload when using this product, do not operate another high-wattage product on the same electrical circuit.
- Avoid the use of extension cords because the extension cord may overheat and cause a risk of fire.

## SAVE ALL INSTRUCTIONS!

**CAUTION:** A short Power Supply Cord is provided to reduce the risk of personal injury resulting from becoming entangled in or tripping over a longer cord. The USB cord provided can be used with a DC5v/1A adaptor or plugged directly into a USB port on a computer. The use of an extension cord is NOT recommended for this item. The cord must be arranged so that it will not drape over the countertop or tabletop where it can be pulled on by children or accidentally tripped over.

## ELECTRIC POWER

If the electric circuit is overloaded by other appliances, your fan and/or appliances may not operate properly. The fan should be operated on a separate electrical circuit from other operating appliances.



## SAFETY WARNING

Although your fan is easy to operate, for your safety, the below warnings must be followed:

1. Do not place the fan near a heat source.
2. Never leave the fan unattended while connected to the electrical outlet.
3. Use the fan on a stable surface away from water.
4. Do not unplug from the socket by pulling on the power cord.
5. The fan must be unplugged and use discontinued:
  - A. Before any cleaning
  - B. After each use
  - C. If it appears to be faulty

**THIS PRODUCT IS INTENDED FOR HOUSEHOLD USE ONLY.**

# LIST OF MAIN PARTS

**FIGURE 1: Front**

1. Front Grill
2. Outer Case
3. Fan Blades (inside the front grill)
4. Aroma Lid
5. Aroma Pad
6. Aroma Box



**FIGURE 2: Back**

7. Rear Grill
8. Power Button
9. Indicator Lights
10. USB Port
11. Micro USB Cord for Charging

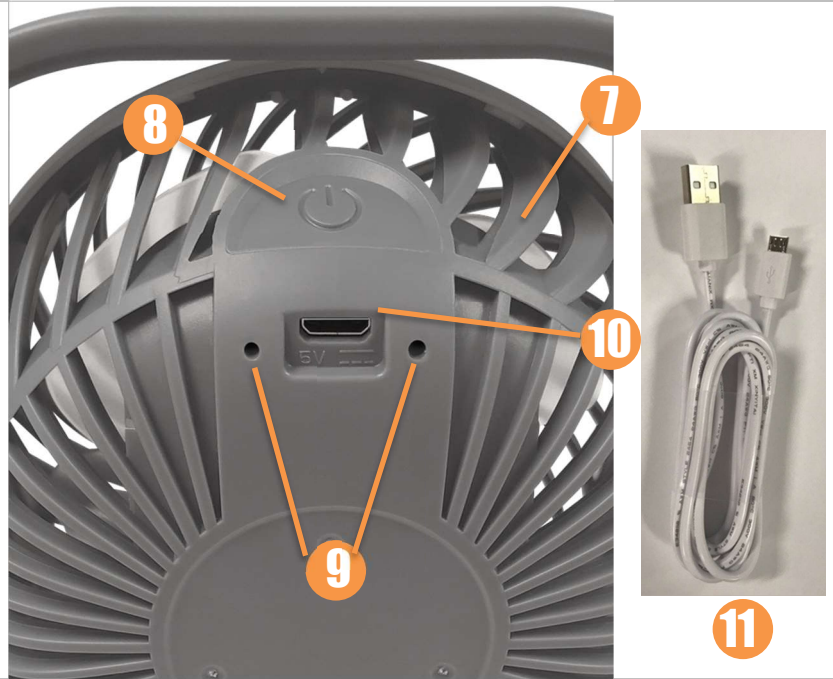

## USE OF ESSENTIAL OIL

- Please follow the recommendations listed below for the proper use of essential oil to avoid causing malfunction/damage to the product or cause harm to the user.
- Only Use essential oils.
- Put 3-5 drops of essential oil onto the aroma pad.
- Do not directly apply undiluted oil to your skin or swallow it.
- Do not allow the oil to come with your skin, wash it off with water. Should you swallow it, seek medical help immediately.
- Some kinds of essential oil are not very soluble in water and tend to remain in the aroma box. Therefore, clean the aroma box as directed.
- Ensure the oil does not get into your eyes. Should it happen, wash your eyes immediately with water. Consult a doctor should irritation persist.
- If you feel unwell while using this product, turn off the device immediately.
- Pregnant women, elderly people, young children or people with chronic disease may be more sensitive to the scent. If they feel unwell, stop using immediately.
- Store essential oil in a dark, cool place with cap tightly closed and out of reach of children and pets.

## OPERATION & USE

### Charge Fan Fully Before First Use

1. Place the fan in the desired location. The fan should be placed on a flat surface to ensure the fan will not be knocked over.
2. Add your favorite aroma into the air by adding your favorite essential oil to the aroma box.  
**CAUTION: Ensure fan is turned OFF when adding or changing oils in the Aroma Box.**
  - A. Grasp the notches on the aroma lid and open it counterclockwise.
  - B. Add 3 to 5 drops of essential oil on the aroma felt pad
  - C. Put the felt pad into the aroma box
  - D. Tighten the notches on the aroma lid clockwise

**NOTE: Avoid adding too many drops of oil.**



3. Manual Adjust the fan to desired angle (up and down) by holding the outer case of the fan and tilting the inner fan desired position of the fan.



### ON/OFF/SPEED Button

To turn the unit power on, **press the button** on the back of the fan to turn on the power. The unit starts operation at LOW speed.

1. When the fan is on press the button to change the speed of the fan. This will cycle from Low, Medium, High and OFF.

## LED Light Indicator

On	White Light
On While Charging (only operates on LOW)	White and Red Lights
Low Battery	Flashing White Light
Charging	Red Light
Full Charge- Plugged in	White Light
Full Charge- Not Plugged in	No Lights
Off	No Lights

### **CHARGING THE FAN** *(Full charge will last up to 17 hours on LOW)*

It is recommended to charge the fan fully before the first use. The fan can be charged while the fan is ON or OFF. Full charging time is 10 hours.

**Charging when OFF:** Plug the micro USB cord into the micro USB socket on the back of the fan and plug the USB end of the cord into a USB port on a computer, or DC5V/1A adaptor plugged into a wall outlet. When fan is OFF while charging, only Red light is ON. Once it is fully charged, Red light will be OFF while White light will be ON.

**Charging when ON:** Plug the micro USB cord into the micro USB socket on the back of the fan and plug the USB end of the cord into a USB port on the computer or DC5V/1A adaptor plugged into a wall. The White and Red indicator lights will be ON. The fan will only operate in LOW speed while the unit is charging. The fan is at full charge when only the White LED light indicator is on.

## MAINTENANCE

### **CAUTION:**

**Always be sure that the fan is switched OFF and unplugged from the power source and unplugged from the USB socket on the back of the fan. Do not immerse fan in water or allow water to drip into the interior of the fan, as this could create an electric shock hazard.**

### **CARE AND CLEANING**

1. Always turn off the fan and disconnect the cord from the electrical outlet and fan before cleaning your fan.
2. Light accumulated dust may be removed from the fan with a soft cloth.
3. Clean the outside of the fan by wiping with a damp cloth and buff with a dry cloth. **DO NOT** use any detergents or abrasives and do not allow any water to enter the fan. **DO NOT** allow water to run into the interior of the fan as this could create a fire or electric shock hazard.
4. **Clean the fan once a month to ensure there is no dust build up that can affect the performance of the fan.**

### **Storing the Fan**

**ALWAYS** store the fan in a cool and dry place when the fan is not in use for an extended time. To ensure that there is no dust build up during storage, we recommend storing the fan unplugged and in an enclosed space.

## CRANE CUSTOMER CARE

**CALL US:** 888-599-0992 (Mon-Fri 9:00am – 4:00pm CST)

**EMAIL US:** [customer-service@crane-usa.com](mailto:customer-service@crane-usa.com)

**LIVE CHAT:** available at [www.crane-usa.com](http://www.crane-usa.com)



# CRANE WARRANTY

For more information regarding the warranty policy,  
please visit our website: [www.crane-usa.com/customer-service](http://www.crane-usa.com/customer-service)

## LIMITED WARRANTY

Thank you for purchasing a Crane product which has been tested to meet our stringent quality standards. This product is warranted to be free from manufacturing defects under normal use and conditions for 1 year.

**PLEASE CONTACT US BEFORE RETURNING THIS PRODUCT TO THE STORE.  
CALL CRANE CUSTOMER CARE FOR PROBLEMS AND QUESTIONS. WE CAN HELP.**

### WARRANTY REQUIRES A DATED PROOF OF PURCHASE.

This warranty is void if the defect is due to accidental damage, misuse, abuse, neglect, improper repair or alteration by unauthorized persons, or a failure to follow operating instructions provided with the product. This warranty does not apply to normal wear and tear or commercial use.

In no event shall liability exceed the purchase price paid by the purchaser of the product. Under no circumstances shall there be liability for any loss – direct, indirect or incidental – or consequential damage arising out of, or in connection with the use of this product.

**This warranty is valid only in the 48 contiguous states plus the District of Columbia** and excludes Puerto Rico and the Virgin Islands. This warranty is effective only if the product is purchased and operated in the United States of America.

Any instructions or warranty included in this manual may be subject to change without notice. For the most up-to-date instructions and warranty information, please contact us or visit our website.

**TO RECEIVE WARRANTY INSTRUCTIONS AND RETURN AUTHORIZATION,  
PLEASE CALL OR EMAIL CRANE CUSTOMER CARE.**

**CRANE USA, INC.**  
1015 Hawthorn Dr., Itasca, IL 60143

Toll Free: 1-888-599-0992 (Monday - Friday 9:00am - 4:00pm CST)

Email: [customer-service@crane-usa.com](mailto:customer-service@crane-usa.com)

Website: [www.crane-usa.com](http://www.crane-usa.com)

*Crane*

DESIGN FOR BETTER LIVING